

# CAL 20703 series

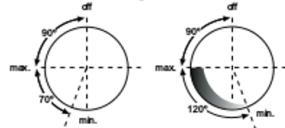

### \_ Rotation diagrams



### \_ Thermocouple connections

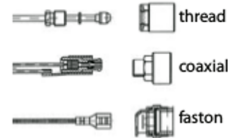

### \_ Construction characteristics

Mechanical body: drop-forged brass and aluminium.  
 Male cone: bar-cut brass and aluminium.  
 Cover: drop-forged steel.  
 Spindle: aluminium (brass optional).

### \_ Other characteristics

Max. ambient temperature: up to 150 °C  
 Max. gas pressure: 65 mbar  
 Stroke: 3,5 mm  
 Flow: 250 l/h (1mbar pressure drop).

### \_ Functional characteristics

Max. tightness at test pressure 150 mbar: < 8 cm<sup>3</sup>/h.  
 Max. turning torque of the spindle: 0.2 N m  
 Max. pushing strenght: 20 N

### \_ Connection characteristics

Inlet types: round 16 mm. diameter ramp. On request and after a study, other types and dimensions.  
 Outlet types: according to customer specifications.  
 Spindle dimensions: according to customer specifications.  
 Distance between clamp holes: 21, 27 and 30 mm. Other types and dimensions on request.

### \_ Installation characteristics

Max. torque for screwing: 3 N m (2 screws) and 2 N m (1 screw).  
 Max. torque of fitting outlet: 8 N m (biconical), 15 N m (flaring).  
 Range for tightening torque of injectors: 1.5 - 2.5 N m  
 Max. tightening torque for fitting thermocouple to record: 4 N m

### \_ Main outside dimensions 45° left outlet

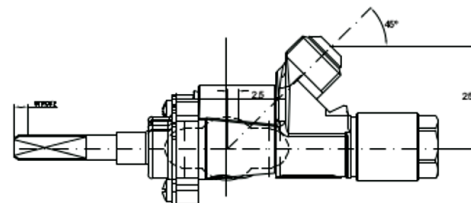
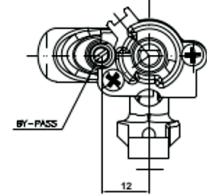
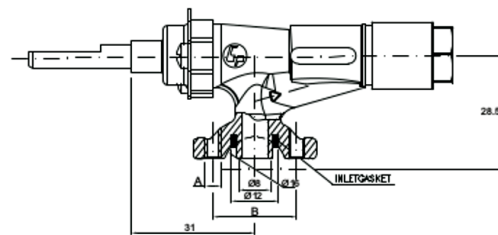

B (mm)	A
21	M4-H6
27	M4-H6 // M5-7H
30	M4-H6 // M5-7H

\_Gas Cooking > Safety Gas Taps  
**CAL 20703 series**

**\_Main outside dimensions**  
**45° right outlet**

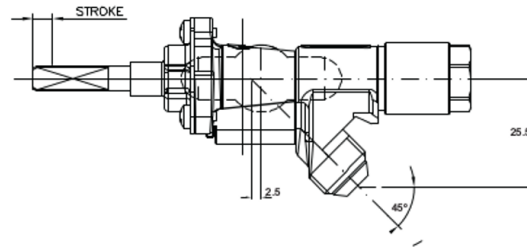
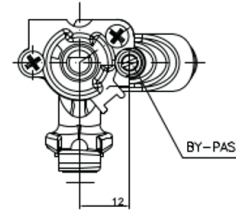
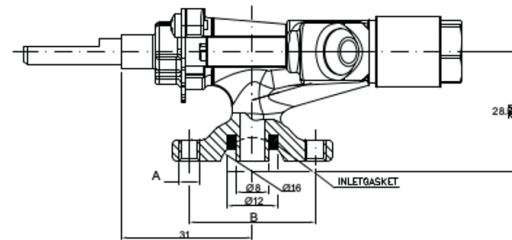

B (mm)	A
21	M4-H6
27	M4-H6 // M5-7H
30	M4-H6 // M5-7H

**\_Main outside dimensions**  
**left parallel outlet**

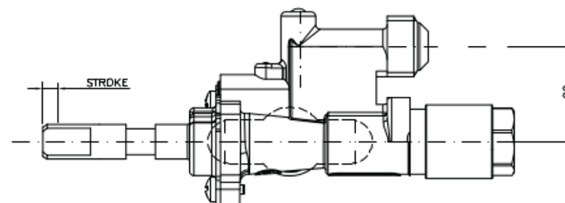
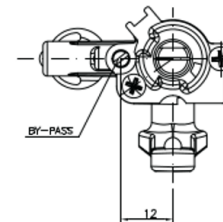
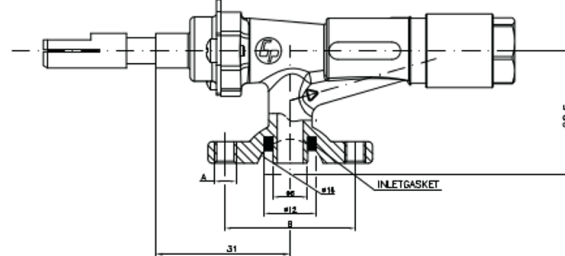

B (mm)	A
21	M4-H6
27	M4-H6 // M5-7H
30	M4-H6 // M5-7H

\* Other versions available upon request.

\_Gas Cooking > Safety Gas Taps  
**CAL 20703 series**

\_Main outside dimensions  
**right parallel outlet**

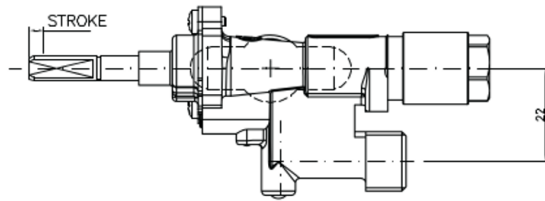
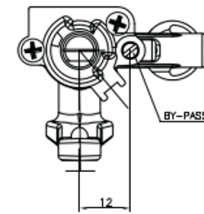
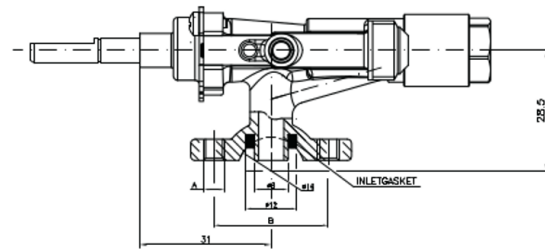

B (mm)	A
21	M4-H6
27	M4-H6 // M5-7H
30	M4-H6 // M5-7H



\* Other versions available upon request.